



Gel Battery

WPPDG12-28(12V28Ah)



HIDDEN IN QUALITY

Specifications

Rated Voltage	12V	
Nominal Capacity	28Ah	(C ₂₀ , 1.80V/cell)
Dimension	Length	166±2mm (6.54 inches)
	Width	175±2mm (6.89 inches)
	Container Height	125±2mm (4.92 inches)
	Total Height	125±2mm (4.92 inches)
Approx Weight	8.50 Kg (18.7 lbs)	
Terminal	M5	
Container Material	ABS	
Rated Capacity (25°C)	28.0 Ah	C20(1.40A, 1.80V/cell)
	24.0Ah	C10(2.40A, 1.80V/cell)
	21.2 Ah	C5(4.23A, 1.75V/cell)
	19.0 Ah	C3(6.34A, 1.75V/cell)
	15.0 Ah	C1(15.0A, 1.60V/cell)
Max. Discharge Current	360A (5s)	
Internal Resistance (25°C)	Approx 13.5mΩ	
Operating Temp. Range	Discharge :	-20 ~ 55°C (-4 ~ 131°F)
	Charge :	-20 ~ 40°C (-4 ~ 104°F)
	Storage :	-20 ~ 50°C (-4 ~ 122°F)
Nominal Operating Temp. Range	25±3°C (77±5°F)	
Cycle Use	Initial Charging Current less than 7.0A. Voltage 14.1V~14.4V at 25°C(77°F)Temp. Coefficient -30mV/°C	
	Initial Charging Current less than 7.0A. Voltage 13.4V~13.6V at 25°C(77°F)Temp. Coefficient -20mV/°C	
Effect of temp. to Capacity	40°C (104°F)	103%
	25°C (77°F)	100%
	0°C (32°F)	86%
Self Discharge	Batteries may be stored for up to 6 months at 25°C(77°F) and then a freshening charge is required. For higher temperatures the time interval will be shorter.	



Layout

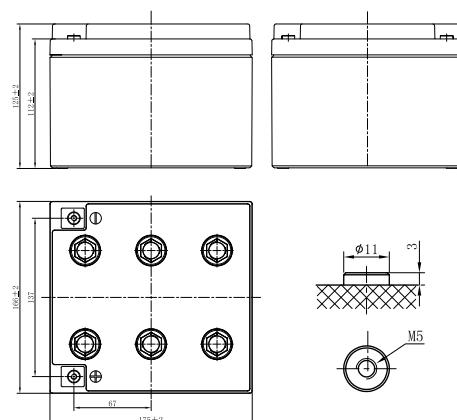

Constant Current Discharge (Amperes) at 25 °C (77°F)

F.V/Time	20min	30min	45min	1h	2h	3h	4h	5h	6h	7h	8h	9h	10h	20h
1.85V/cell	20.5	16.4	12.8	10.9	6.46	5.60	4.50	3.88	3.35	2.96	2.66	2.42	2.30	1.34
1.80V/cell	23.5	18.3	14.1	12.0	6.98	6.00	4.77	4.08	3.52	3.09	2.79	2.54	2.40	1.40
1.75V/cell	26.4	20.2	15.2	12.9	7.40	6.34	4.99	4.23	3.64	3.20	2.88	2.62	2.44	1.42
1.70V/cell	28.5	21.6	16.2	13.6	7.85	6.60	5.16	4.37	3.77	3.31	2.97	2.68	2.50	1.45
1.67V/cell	29.6	22.5	16.7	14.1	8.05	6.81	5.29	4.45	3.82	3.36	3.01	2.73	2.53	1.46
1.60V/cell	32.1	24.0	18.0	15.0	8.38	7.08	5.49	4.60	3.92	3.44	3.07	2.78	2.59	1.48

Constant Power Discharge (Watts/cell) at 25 °C (77°F)

F.V/Time	20min	30min	45min	1h	2h	3h	4h	5h	6h	7h	8h	9h	10h	20h
1.85V/cell	39.3	31.6	24.8	21.2	12.6	11.0	8.84	7.66	6.62	5.88	5.30	4.81	4.58	2.68
1.80V/cell	44.3	35.0	27.1	23.4	13.6	11.7	9.39	8.02	6.93	6.13	5.54	5.05	4.78	2.79
1.75V/cell	49.3	38.1	29.1	24.9	14.4	12.3	9.72	8.30	7.16	6.33	5.71	5.19	4.87	2.85
1.70V/cell	52.5	40.5	30.7	26.1	15.1	12.9	10.1	8.53	7.39	6.53	5.87	5.33	4.98	2.88
1.67V/cell	54.0	41.6	31.5	26.9	15.5	13.2	10.3	8.69	7.49	6.61	5.95	5.38	5.02	2.91
1.60V/cell	58.0	44.2	33.6	28.5	16.0	13.7	10.6	8.93	7.65	6.74	6.04	5.48	5.12	2.94



Gel Battery

WPPDG12-28(12V28Ah)



HIDDEN IN QUALITY

Applications

- Communication power supply
- Solar system
- Wind power system
- Engine starting
- Wheelchair, Floor cleaning machines, Golf trolley, Boats

General Features

- Battery design life up to 12 years
- High thermal capacity reduce the risk of thermal out of control and drying hard, and the battery can be used in bad environment
- Little water losing, and no electrolyte stratification phenomenon

Discharge Characteristics

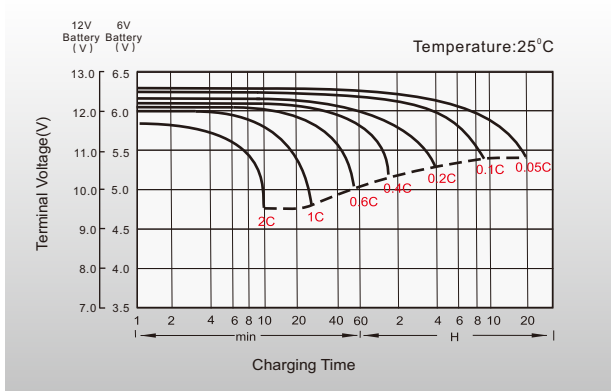

Float Charging Characteristics

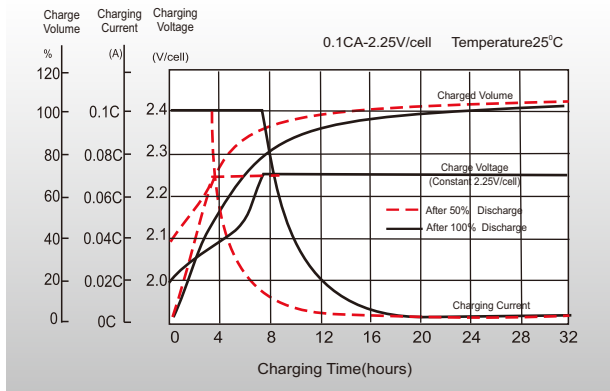

General Relation of Capacity VS. Storage Time

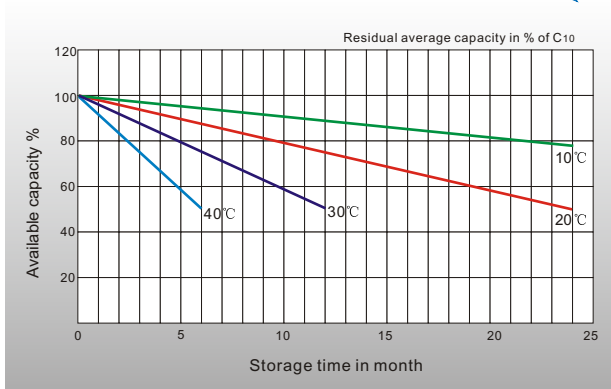

Effect of Temperature on Long Term Float Life

